

9

Reassemble and reconnect anything you may have taken apart prior to this installation. Connect your computer to the Control Module and access the TanLink software. **The new Evacuation Pump will not work properly without changing these parameters.**

Click "Connect to Controller"

Then "View/Edit Cycle Times"

Click "Drain"

Change "Stop Time" to 170

OK

OK

Click "View/Edit Drain Pump PWM"

Click "Control Settings"

Uncheck "Hexidecimal" and numeric values will appear below

Set "Starting duty cycle" to 50

Set "Maximum duty cycle" to 50

Set "Low voltage hold time" to 0

Recheck "Hexidecimal"

OK

"Disconnect From Controller"

Your new Evacuation Pump is now ready to run.

Sunless *Express*TM Evacuation Pump Upgrade Kit

Before you begin

Disconnect power from the unit and turn off the water supply. You may find it helpful to remove the water heater and the bucket it sits in.

You will need Allen wrenches in 1/8", 5/32" and 3/16" sizes, a 9/16" wrench and a channel-lock pliers for removing and installing hoses and fittings.



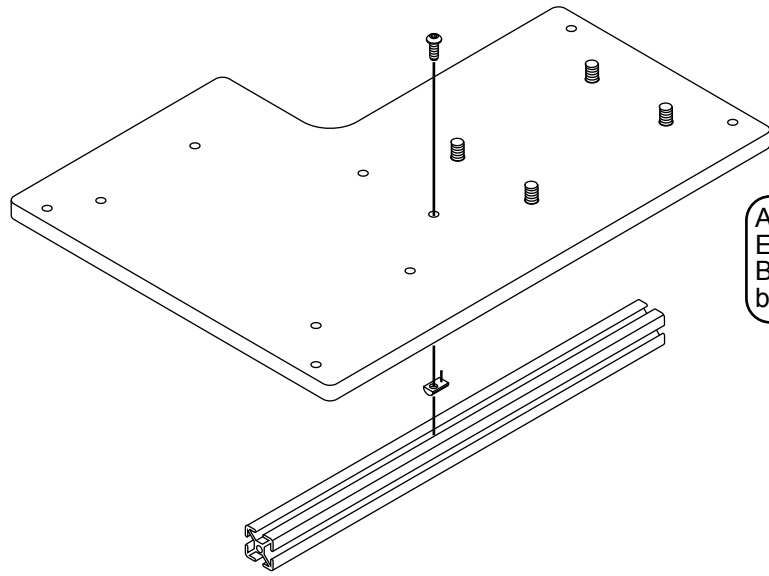

①

Attach the Support Extrusion to the Pump Board with a 1/4-20 x 3/4" bolt and 1/4-20 T-nut.

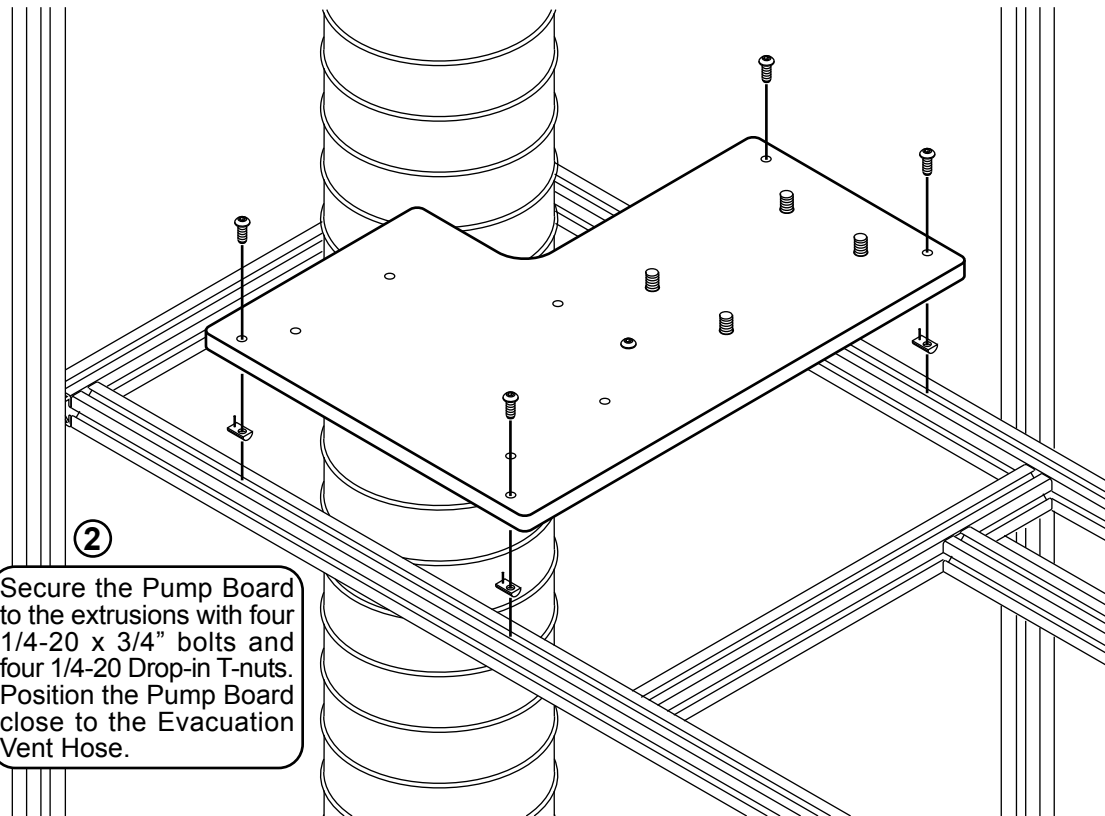

②

Secure the Pump Board to the extrusions with four 1/4-20 x 3/4" bolts and four 1/4-20 Drop-in T-nuts. Position the Pump Board close to the Evacuation Vent Hose.

⑧

Make the electrical connections. The Evacuation Pump plugs into the left side of the Power Box. The main power cord, from the wall, plugs into the right side of the Power Box. The power cord supplied with this kit runs from the Power Box to the Control Module.

The two wires coming from the bottom of the Power Box connect to the wire harness controlling the old Evacuation Pump. Tuck all wires into the conduits.

Connect the hoses. The Base Drain Hose connects to the left side of the Evacuation Pump and the Drain Hose connects to the right side.

EVACUATION PUMP

CONTROL MODULE

MAIN POWER

TO EVACUATION PUMP CONTROL HARNESS

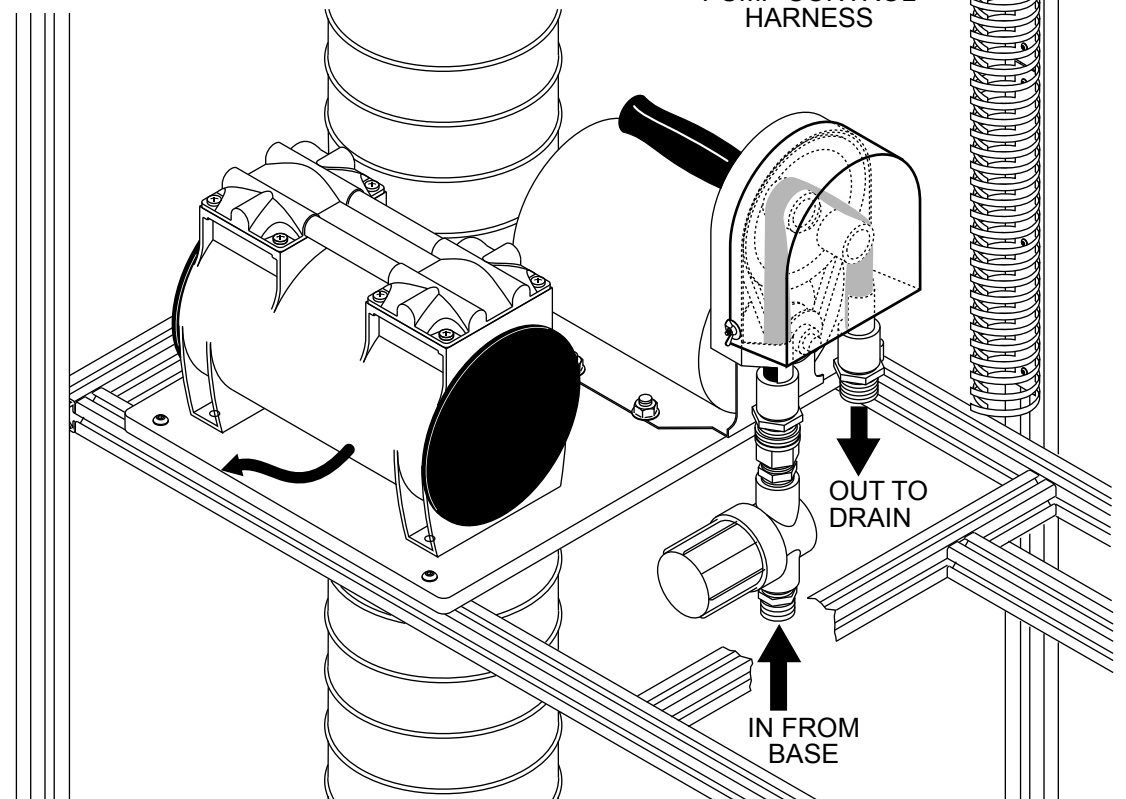

7

Mount the Power Box to the rear middle Control Cabinet extrusion with two 5/16-18 x 1" bolts and 5/16-18 Drop-in T-nuts. Do the same with the Cable Conduits using #10-32 x 3/8" bolts and #10-32 Drop-in T-nuts.

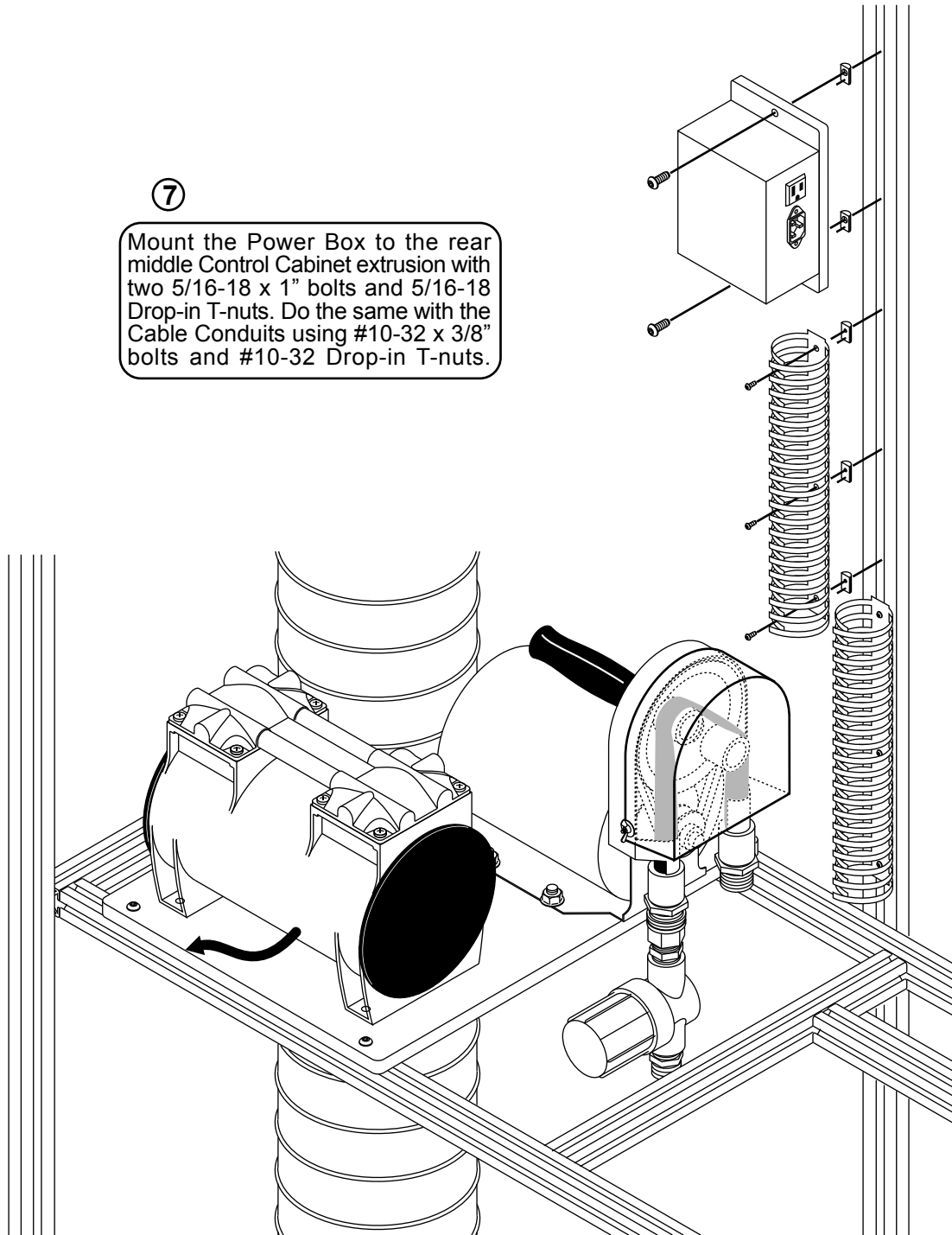

3

Attach the Support Extrusion to the side extrusions from the underside with the Board Support Brackets, 1/4-20 x 3/4" bolts and 1/4-20 T-nuts.

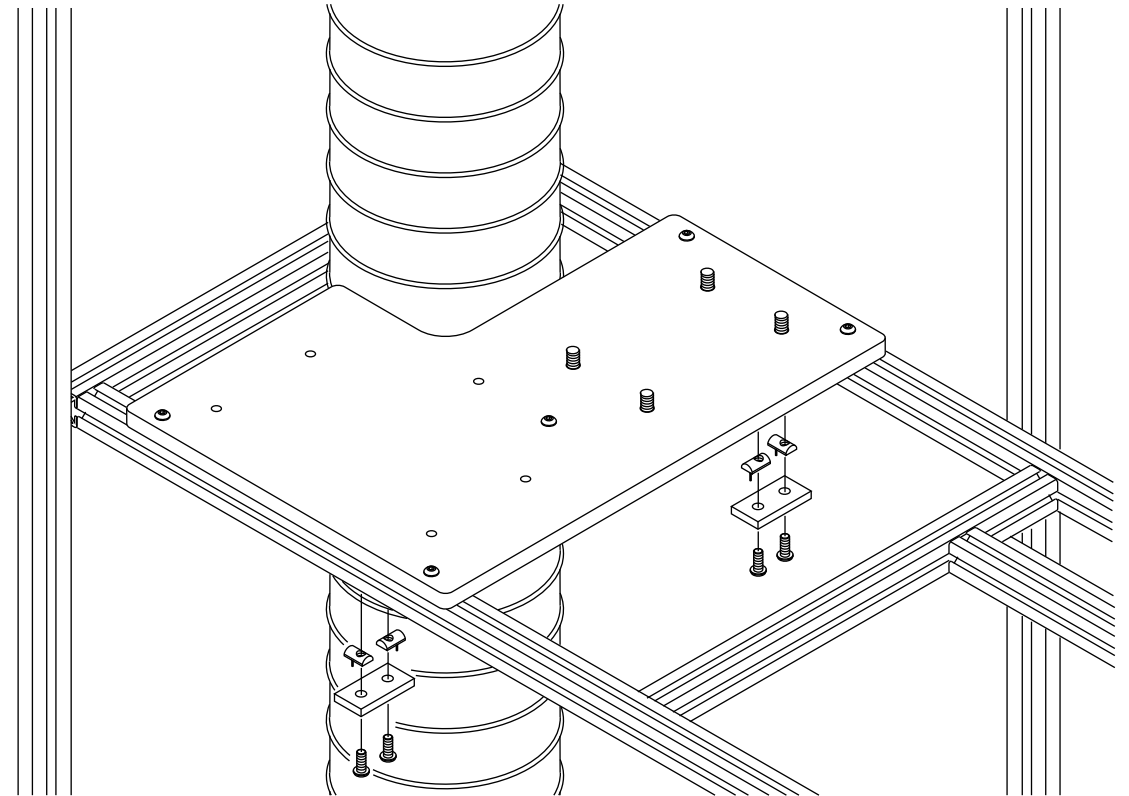

④

The Evacuation Pump mounts to the Pump Board on the pre-installed bolts using four 5/16-18 Locknuts.

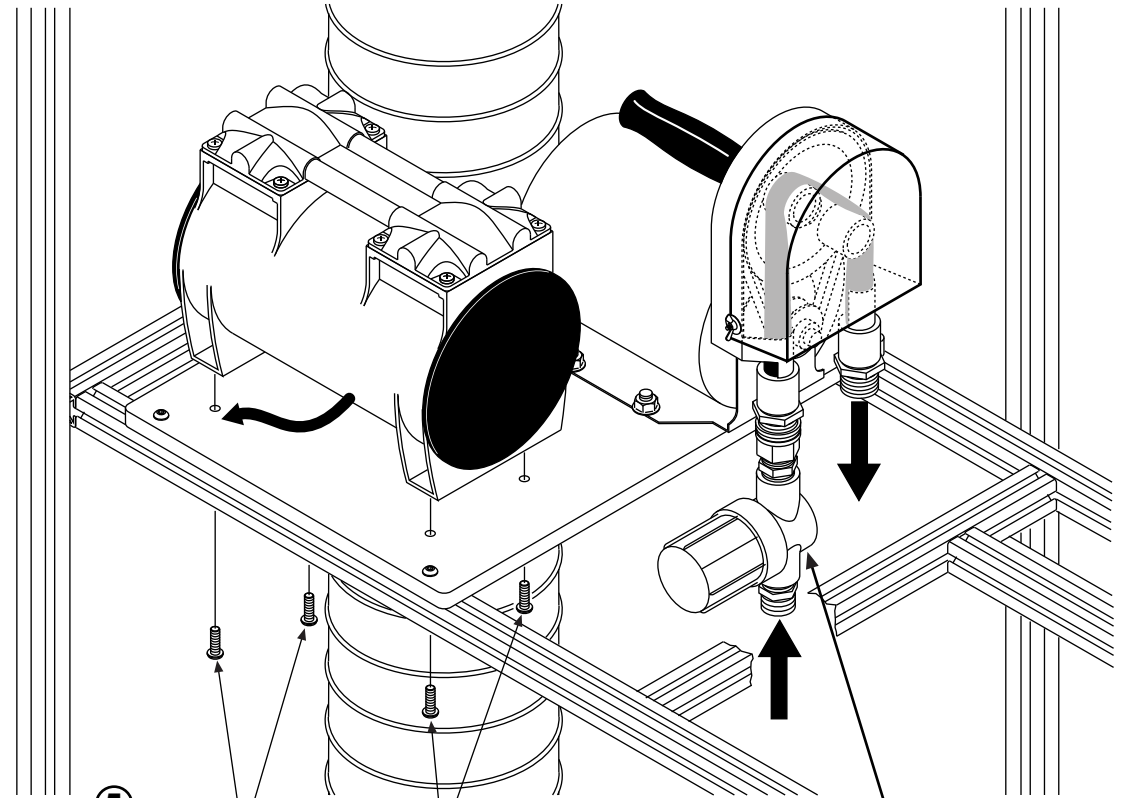
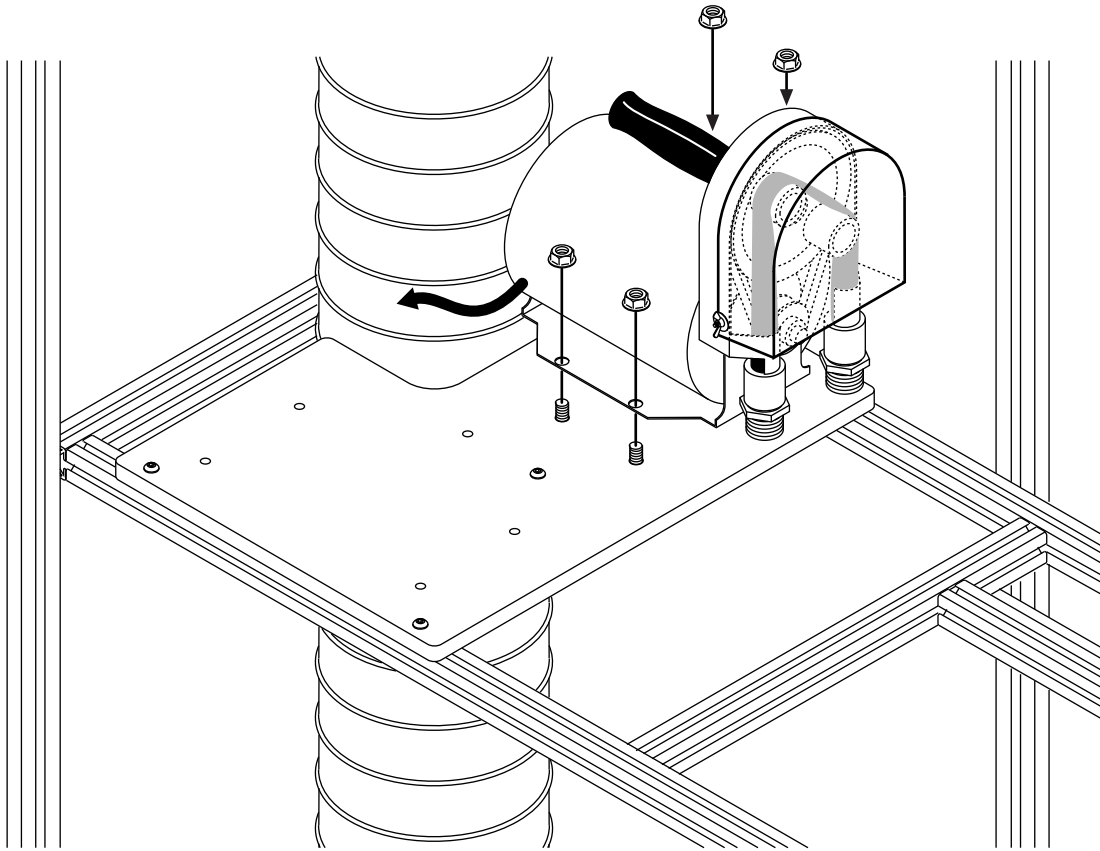

⑤

Remove the rubber feet from the Air Pump and secure it to the Pump Board with four 1/4-20 x 1" bolts.

⑥

Remove the Filter from the old Evacuation Pump. Disassemble the 90° elbow and male fitting from the intake side of the filter and install the male fitting to the intake side.

Then install the filter to the intake (left) side of the new Evacuation Pump.

